

**SPEEDSTER**

RAPID PROFILE PROTECTION

# Operating instructions for the Speedster protection tape application tool

[www.obexuk.com](http://www.obexuk.com)



The Speedster protection tape applicator is an efficient and effective way of applying protection tape to lengths of extrusion. Using and reloading the tool is quick and easy, simply follow the steps on the subsequent pages.

---

## Tips and warnings

- » Be extremely careful of the sharp cutting blade. Keep out of reach of children.
- » To ensure good results, the Teflon guiding strip must be in contact with the edge of the profile at all times during taping. This will keep the tape application straight.

1

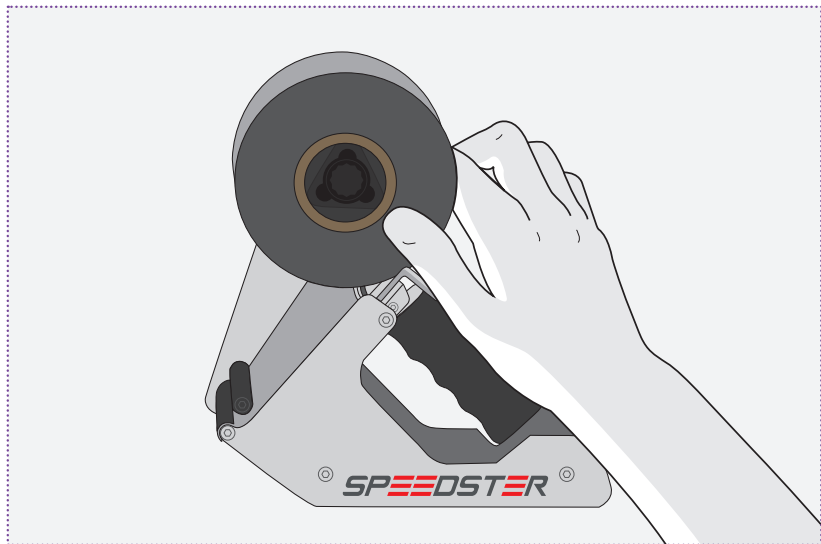

Attach the roll of protection tape onto the triangular roll holder at the top of the Speedster. Attach the roll of tape so it will unwind with the sticky side facing outwards.

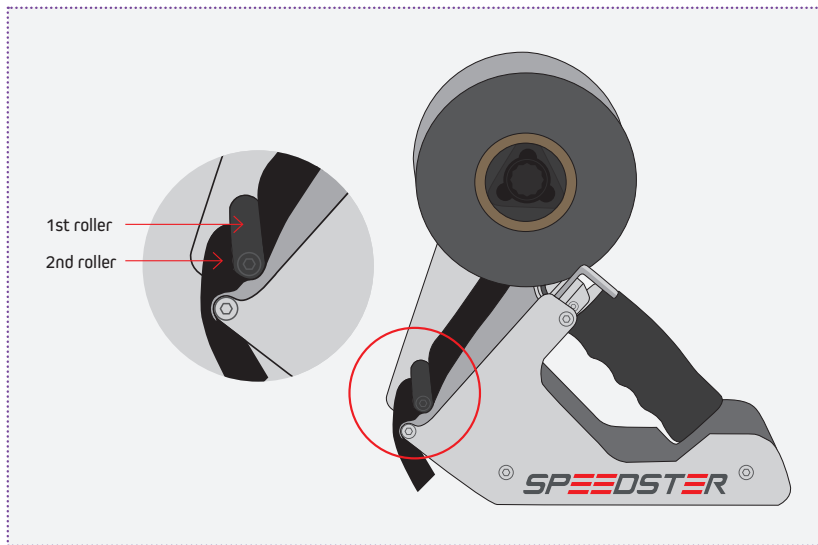

Pull the end of the tape under the first roller and over the second roller as indicated. The sticky side of the tape should be facing out from the tool.

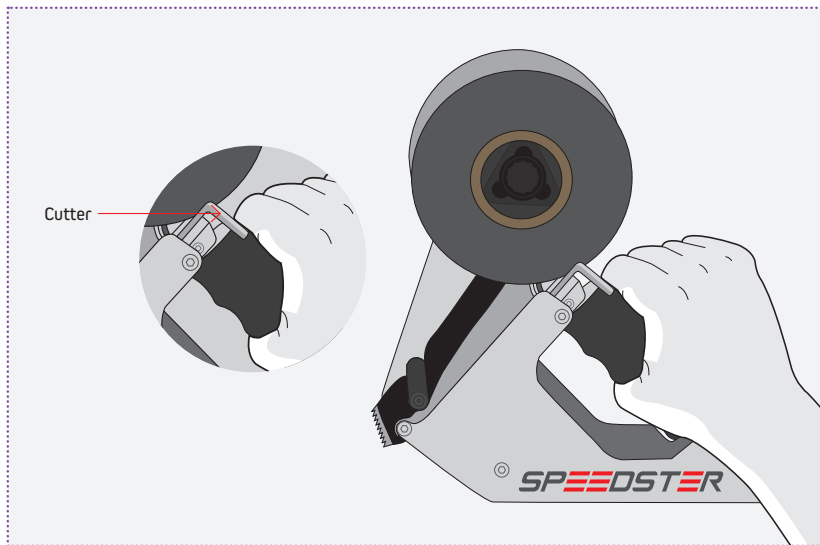

Cut the tape by using the cutter. This ensures the tape is in the correct position to start taping.

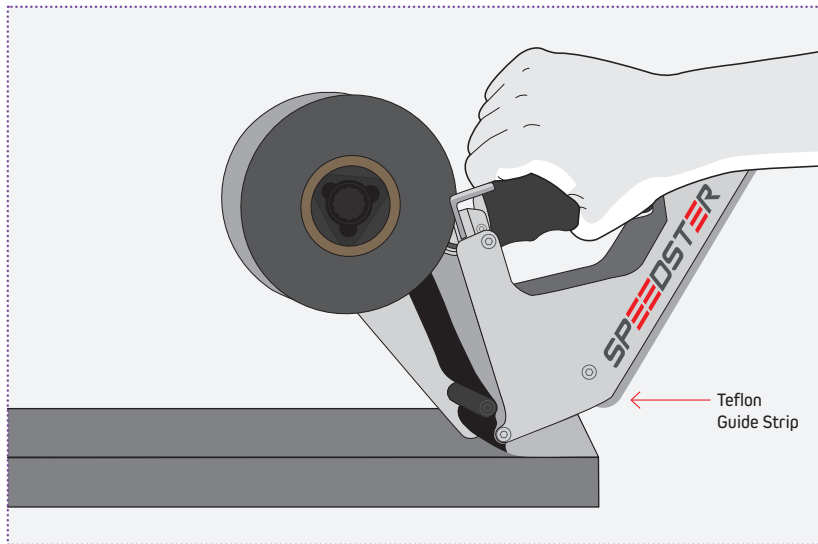

To start applying the tape to a profile, lower the front of the Speedster as indicated, checking the Teflon Guide Strip is running along the edge of the profile.

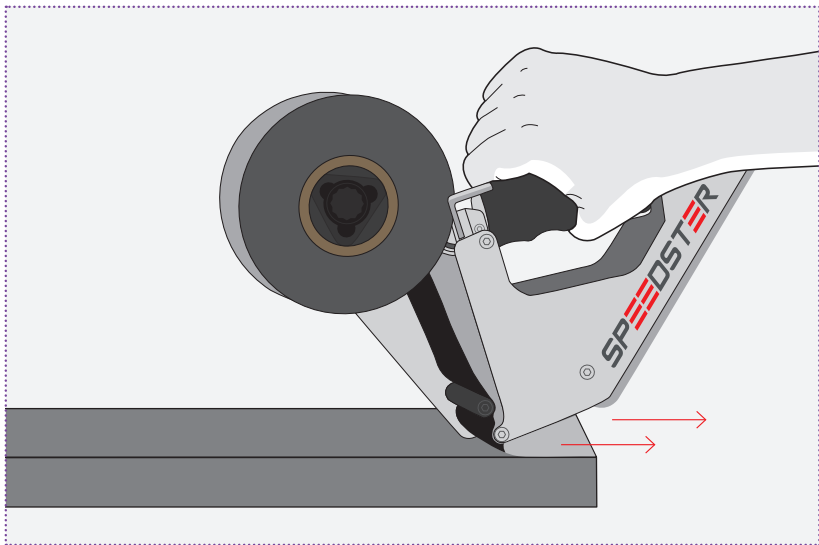

Pull the tool backwards a few millimetres to ensure the tape has adhered securely to the profile surface.

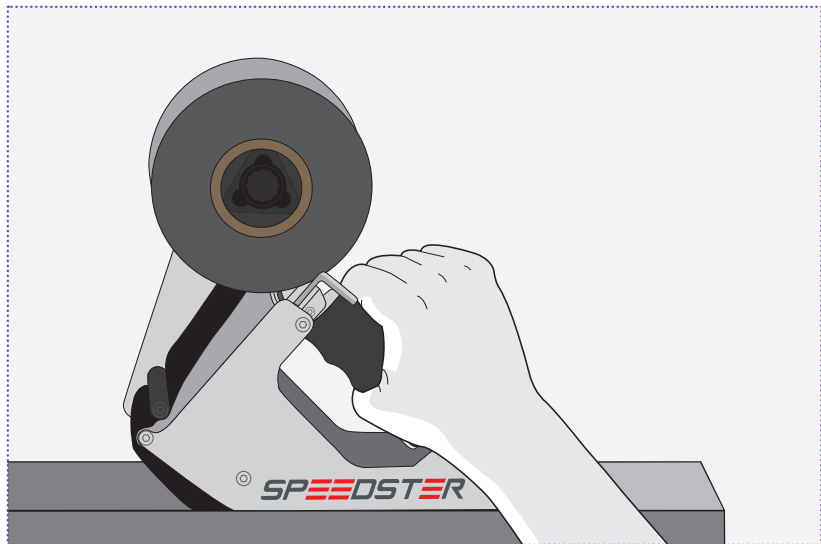

Now push the Speedster forward, lowering the back of the Speedster down until both large rubber rollers are sitting flat on the profile surface.



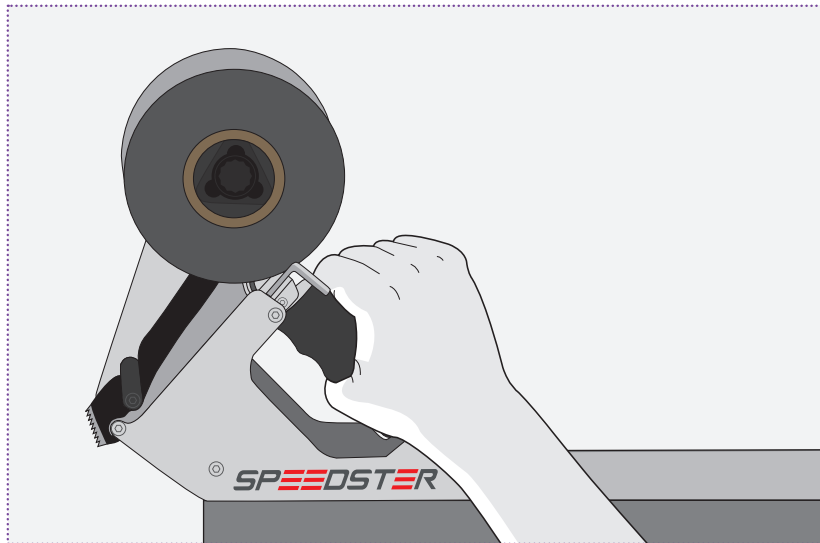

Push the Speedster forward until you reach the end of the profile then activate the cutter with the thumb lever. You should have one perfectly protected profile!



For technical assistance, call **01905 337800**, email **[sales@obexuk.com](mailto:sales@obexuk.com)**  
or visit **[www.obexuk.com](http://www.obexuk.com)**